

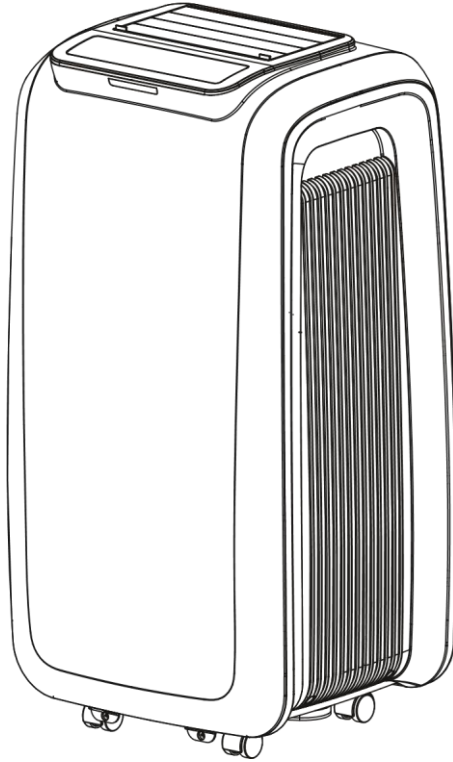

AC12 AC12HP



Portable Air Conditioner

USER MANUAL

THANK YOU

Thank you for choosing this innovative Amcor air conditioner. We suggest that you keep this manual in a safe place for future reference. It describes the many benefits and advanced features this unique product has to offer. Before you use your new air conditioner you should carefully read these instructions to maximise this product's performance.

For over 60 years Amcor has specialised in complete indoor environmental control, manufacturing and marketing; dehumidifiers, portable air conditioners, coolers, air purifiers, ionisers and aroma therapy scent diffusers. These world class products incorporate the latest technological developments.

QUICK VISUAL SAFETY GUIDE ON WHERE OR WHEN NOT TO USE YOUR DEHUMIDIFIER



Exposed to the weather outdoors



Near water



If the power cable wires are frayed or cut



Where small children may be left unattended



If an extension lead may become overloaded



Where it may be damaged by chemicals



Where the power cable may be damaged

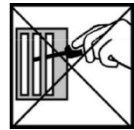

Where there is a risk of interference by foreign objects



On a slope or uneven surface



This product is not for DIY repair



Where there is a risk of fire, or close to a naked flame



Where there is a risk of water falling on the unit

SAFETY INSTRUCTIONS

IMPORTANT

- Carefully read the instructions before operating the unit.
- This appliance is for indoor use only.
- Rating: This unit must be only connected to a 220-240 V / 50 Hz earthed outlet.
- Installation must be in accordance with the regulations of the country where the unit is used.
- If you are in any doubt about the suitability of your electrical supply have it checked and, if necessary, modified by a qualified electrician.
- This air conditioner has been tested and is safe to use. However, as with any electrical appliance - use it with care.
- Disconnect the power from the appliance before dismantling, assembling or cleaning.
- Avoid touching any moving parts within the appliance.
- Never insert fingers, pencils or any other objects through the guard.
- This appliance can be used by children aged from 8 years and above and persons with reduced physical, sensory or mental capabilities or lack of experience and knowledge if they have been given supervision or instruction concerning use of the appliance in a safe way and understand the hazards involved. Children shall not play with the appliance. Cleaning and user maintenance shall not be made by children without supervision.
- Do not clean the unit by spraying it or immersing it in water.
- Never connect the unit to an electrical outlet using an extension cord. If an outlet is not available, one should be installed by a qualified electrician.
- Never operate this appliance if the cord or plug is damaged. Ensure the power cord is not stretched or exposed to sharp objects or edges.
- A damaged supply cord should be replaced by the manufacturer or a qualified electrician in order to avoid a hazard.
- Any service other than regular cleaning or filter replacement should be performed by an authorized service representative. Failure to comply could result in a voided warranty.

- Do not use the appliance for any purpose other than its intended use.
- The air conditioner must always be stored and transported upright, otherwise irreparable damage may be caused to the compressor; if in doubt we suggest waiting at least 24 hours before starting the unit.
- Avoid restarting the air conditioner unless 5 minutes have passed since being turned off. This prevents damage to the compressor.
- Never use the mains plug as a switch to start and turn off the air conditioner. Use the provided ON/OFF button located on the control panel.
- Always place the unit on a dry and stable surface.
- The appliance should not be installed in laundry or wet rooms.

Energy Saving and Unit Safety Protection Tips

- Do not cover or restrict the airflow from the outlet or inlet grills.
- For maximum performance the minimum distance from a wall or objects should be minimum 50cm.
- Keep the filters clean. Under normal conditions, filters should only need cleaning once every three weeks (approximately). Since the filters remove airborne particles, more frequent cleaning may be necessary, depending on the air quality.
- For the initial startup set the fan speed to maximum and the thermostat to 4-5 degrees lower than the current temperature. After, set the fan switch to low and set the thermostat to your desired setting.
- To protect the unit we recommend not using the cooling function when the ambient temperature is higher than 35 °C.

PARTS

Front Side

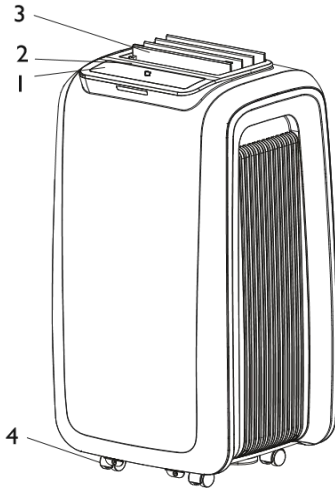

Back Side

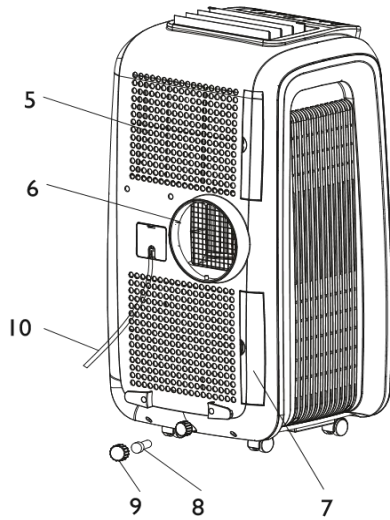

- | | | |
|-----------------------|-----------------------|-------------------------|
| 1. Control Panel | 2. Air outlet | 3. Self closing louvres |
| 4. Castors | 5. Upper filter frame | 6. Exhaust outlet |
| 7. Lower filter frame | 8. Rubber stopper | 9. Drain screw cap |
| 10. Power cord | | |

Check that all accessories are in the box and please read the instructions manual before assembling the unit.

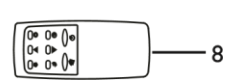
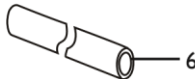
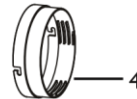
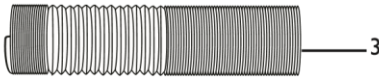
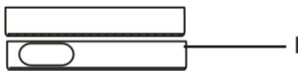

- | | |
|---|---------------------------------------|
| 1. Extendable slide bar | 2. Screw, washer, nut (for slide bar) |
| 3. Extendable exhaust hose (up to 1.5 meters) | 4. Hose connector |
| 5. Fishtail adapter | 6. 10mm Drain pipe (AC12HP only) |
| 7. Drain connector (AC12HP only) | 8. Remote control |

INSTALLATION

Warning: Before using this unit, please keep it upright for at least 3-4 hours.

This unit can easily be moved from one room to another.

While moving the unit please note that it must be kept upright and then placed on an even surface.

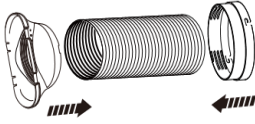

1. Extend one end of the hose and connect the hose connector, by twisting it a number of full rotations.
2. In the same way connect the fishtail adapter to the opposite end of the exhaust hose.

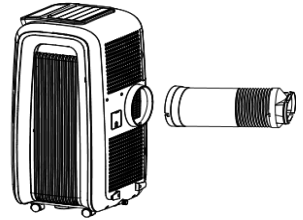

3. Twist the hose connector into the exhaust outlet on the rear of the unit.

INSTALLATION OF WINDOW KIT

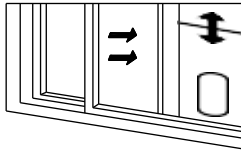
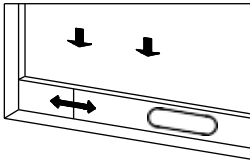

The window kit (slide bar and fishtail) can be used with sliding windows and doors. For other types of window, the fishtail should be used on its own.

1. Partially open the window and then fix the window kit to fill the opening in the window.

2. Make sure the unit is upright and there are no obstructions to the air inlet grills.

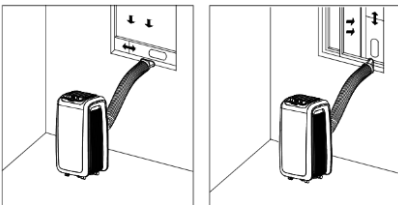

3. With the hose and fishtail adaptor connected to the unit, push the end of the fishtail adaptor into the slot in the slide bar.

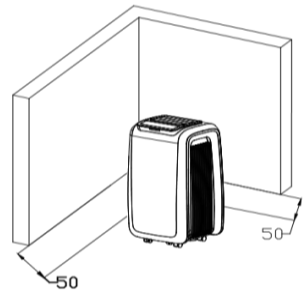

NOTES:

- To ensure efficient operation the opening should be as small as possible.
- The best form of installation is through a wall duct.
- The unit will need to be externally in heating mode (AC12HP only), ideally through the wall. By properly venting you expel cold air from your room while efficiently heating it.
- Your air conditioner should be used without a vent hose in dehumidifier mode. Please ensure an external water tank is used, monitored and regularly emptied before over spilling. Permanent plumbing can be also installed in dehumidifier mode, alternatively an external water pump can be fitted for unattended use.

IMPORTANT SAFEGUARDS

The length of the soft hose extends from 28 cm to 150 cm. If the hose is extended above this length the unit may malfunction and this can invalidate the warranty.

The outlet vent must be well ventilated and not obstructed as this will cause the unit to overheat. Avoid bending the hose more than 30°.

FEATURES AND OPERATION

FEATURES

1. Self-evaporative system - no external water tank needed
2. Designer inspired luxury model
3. Louvres outlet closes when shutting down the unit, this prevents dust and dirt entering the machine.
4. Bright LED screen, indicates temperature and operation mode
5. On/Off timer function – allows you to choose when the unit operates.
6. Compressor protection technology

OPERATION

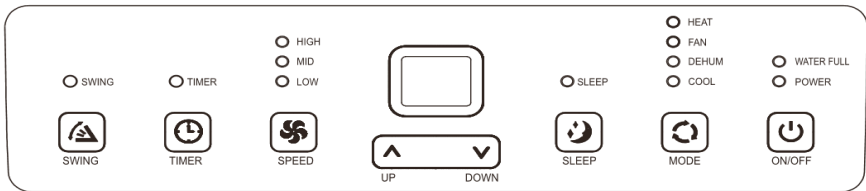

ON/OFF

Press "POWER" to switch the unit On or Off

COOLING MODE

After the machine is turned on, it will automatically enter cooling mode with a desired temperature of 22°C and low fan speed.

Press "MODE" to select cooling mode, the cooling mode indicator will be lit.

Press the "UP" and "DOWN" buttons to adjust the desired temperature (between 16°C and 31°C).

Press "SPEED" to select the fan speed (high, medium and low).

HEATING MODE (AC12HP)

Press "MODE" to select heating mode, the heating mode indicator will be lit.

Press the "UP" and "DOWN" buttons to adjust the desired temperature (between 16°C to 31°C).

Press "SPEED" to select fan speed (high, medium and low).

DEHUMIDIFY MODE

Press "MODE" to select dehumidify mode, the dehumidifying mode indicator will be lit.

When using dehumidify mode the sleep function cannot be used and the fan speed is low.

The dehumidifier does not need to be externally vented, but continuous drainage should be set up for the moisture collected.

FAN MODE

Press "MODE" to select fan mode, the fan mode indicator will be lit.

Press "FAN" to select fan speed (high, medium and low).

Desired temperature and sleep function cannot be used.

TIMER MODE

You can only set the auto-shut off timer while the unit is operating (On).

You can only set the auto-start timer while the unit is in standby (Off).

Under standby mode, press "TIMER" to setup the power-on time. The timer indicator turns will be lit.

Under power-on mode, press "TIMER" to setup power-off time. The timer indicator turns will be lit.

Use the "UP" and "DOWN" buttons to adjust the duration of the timer between 1-24 hours.

Timer functions cannot be repeated or combined.

Manual power on / off operations will cancel the timer.

FEATURES AND OPERATION

SLEEP MODE

While in cooling pressing the "SLEEP" button will put the unit in sleep mode.

The fan speed will change to low.

It will automatically increase the desired temperature by 1°C after an hour and by a further 1°C after a further hour. This means the unit will spend less time with the compressor running, and so run quieter.

The sleep function cannot be used in dehumidify and fan modes.

If the water tank is filled, the unit is put into standby or the mode is changed, sleep mode will be cancelled.









SWING MODE

After machine turns on, press the "SWING" button, the inner louver will swing continuously left and right; by pressing the button again the movement will stop and the louver remain in that position.

COMPRESSOR PROTECTION

There is a 3 minutes compressor start delay after power on or restart.

REMOTE CONTROL

1. Power  : Press to turn the unit on/off.
2. TIMER : Press to set the timer. Once set, selected duration will flash 5 times as confirmation. Under power-on or standby mode, press this button to setup the on/off timer between 1~24.
3. Down : Press to decrease the desired temperature, or the timer duration after pressing the timer button.
4. Mode : Press to choose between cooling, heating (AC12HP only), dehumidifying or fan modes.
5. Up : Press to increase the desired temperature, or the timer duration after pressing the timer button.
6. Fan : Press to change between low/medium/high fan speeds.
7. Sleep : (Only in cooling mode) : Press to enable sleep mode.
8. Swing  : Press to control swing function.

The air conditioner responds to all signals that are sent by the remote control. Two AAA-batteries are required to use the remote control.

Note: the air flow direction cannot be adjusted with the remote control.

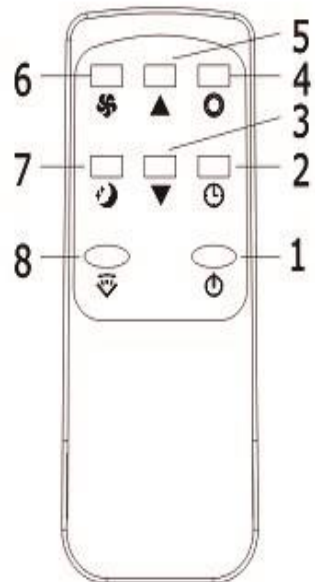

IMPORTANT:

There is a 3 minutes delay on power on. In order to protect the life of the compressor and electronic components please do not switch on the unit for at least 5 minutes after you turned the unit off.

WATER-DRAINAGE

MANUAL DRAINAGE

When the internal water tank is full the unit will stop working. Shut off the unit and unplug. Avoid moving the model abruptly as this may cause water to spill from the internal tank.

Place a tray under the water plug.

Unscrew the Drain plug cap and remove the rubber stopper - water will drain from the internal tank.

Put the rubber stopper back and screw the drain plug cap back into place.

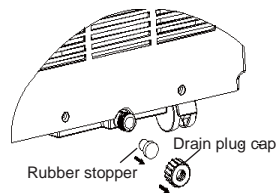

CONTINUOUS DRAINAGE:

Unscrew the drain plug cap and remove the rubber stopper. Fit the drain connector within the cap

Connect a suitable pipe to the water outlet to remove the water out continuously.

Note: This model is self-evaporative, which reduces the need to empty the water tank.

If the unit is vented correctly most of the water is reused to cool the condenser coils and any excess is evaporated.

Please do not use continuous drainage if you intend to use the self-evaporate facility.

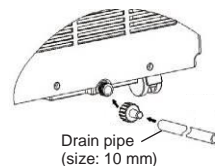
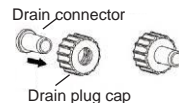

MAINTENANCE

CLEANING

Turn off the unit and unplug from the mains before cleaning or performing any maintenance.

CLEAN THE SURFACE

Clean the plastic housing with a duster or a soft wet cloth.

Do not use chemical solvents (such as benzene, alcohol or gasoline) as they may cause irreversible damage.

AIR FILTER CLEANING

Clean the air filters every 2 weeks. If the air filter is blocked with dust, the performance of the unit will be significantly affected.

Pull out the top and bottom filters as pictured below

Wash the air filters by immersing them in warm (about 40°C) water with a neutral detergent.

Rinse it and then dry it thoroughly.

Carefully re-install air filters

END OF SEASON MAINTENANCE

1. Pull out the plug from the drainage hole and empty the internal tank. You should ensure the tank is fully drained by leaning the unit backwards.
2. Then switch the unit to Fan mode,
3. Keep the unit in this mode for half day. Doing this helps to keep the inside of the unit dry and prevents mold developing
4. Turn off the unit and unplug
5. Ensure the water tank is empty before replacing the rubber bung and drain cap.
6. Coil the wire and bind it together, then put it into the accessories space.
7. Separate the air-exhausted pipe and store it safely.
8. Cover the unit and keep it in a dry place.
9. Take the batteries out of remote control and store, or dispose, them safely

TROUBLESHOOTING

Do not repair or disassemble the unit by yourself, unauthorized repair attempts will invalidate the warranty and may cause bodily harm.

Problem	Reason	Solution
The unit does not work	No power supply.	Plug in and turn on the unit.
	Water-full indicator illuminated.	Drain the internal water tank.
	Timer function is active.	Cancel the timer function.
	Room temperature too low or too high.	Use only in ambient temperatures between 7-40°C.
The unit does not seem to perform.	In direct sunlight.	Draw the curtains, UV affects use air conditioner.
	Windows or doors open. Large amount of people or a heat source in the room.	Close windows and turn on another air conditioner.
	Filter is very dirty.	Clean or change the air filter
	Air inlet or air outlet is blocked	Clear out debris.
	Room temperature is lower than the desired temperature set.	Change the desired temperature.
The unit is loud	The unit is not on a flat surface.	Put the unit on flat surface. Place a piece of carpet under the unit to prevent vibrations.
Compressor does not work	Overheating protection is active.	Check the vent pipe is not restricted. Restart the unit after 10 minutes when compressor has cooled.
Remote control doesn't work	Operating distance is too far.	Move remote control closer to the unit and make sure it aims at the air-outlet grille.
	Control panel has not received the signal from remote control.	
	The batteries are flat.	Replace the batteries
E1 on LED	Room temperature sensor is abnormal.	Temperature not within 5-40°C operating range. If the temperature within operating range refer to the retailer or manufacturer.
E2 on LED	Coil temperature sensor is abnormal.	Refer to the retailer or manufacturer.
OTHERS	Water tank is full inside the machine	Drain water from drain port at bottom rear of the unit.
	Anti-freezing protection.	Defrosting the coils within the unit. Normal operation will resume automatically. No user input is required.
	No refrigerant or there is very little refrigerant.	Refer to the retailer or manufacturer.
	High pressure protection.	After inside gas pressure comes down, it will function normally. No user input needed.

If the above solutions do not resolve the problem please contact the retailer or manufacturer.

APPENDIX



Disposal: Do not dispose this product as unsorted municipal waste. Collection of such waste must be handled separately as special treatment is necessary.

Recycling facilities are now available for all customers at which you can deposit your old electrical products. Customers will be able to take any old electrical equipment to participating civic amenity sites run by their local councils. Please remember that this equipment will be further handled during the recycling process, so please be considerate when depositing your equipment. Please contact the local council for details of your local household waste recycling centres.

TECHNICAL DATA

Model		AC12/AC12HP	
Cooling Capacity	KW/BTU	3.51/12000	
Heating Capacity	KW/BTU	2.93/10000	
Cooling Rated Input	W	1500	
Heating Rated Input	W	1270	
Mains		220-240 V / 50 Hz	
Current Cooling / Heating	A	5.97/5.62	
Refrigerant		R410A	
Moisture Removal	L/Day	50	
EER Rating		A	
Permitted Excessive Operating Pressure Suction / Discharge	MPa	0.8/3.2	
Maximum Allowable Pressure	MPa	5.0	
Compressor		Rotary	
Fan Speed		3	
Noise	dB(A)	Sound Pressure	≤54
		Sound Power	≤65
Thermostat	°C	16-31	
Timer	h	1-24	
Fuse Parameter		Type: FSD / 50F Voltage: AC 250V;F;3.15AL	
Net Weight	kg	29	
Dimension(L*D*H)	mm	400 x 370 x 800	
Unit must be vented outside when in Air Cooling mode. For the purposes of EU regulation EN12102 this is a local air conditioner and produces less than 65dB(A) sound energy			

AMCOR UK SUPPORT

Please, for your own convenience, make these simple checks before calling the service line

Has the unit been standing upright? (for at least 2 hrs)

Is the unit plugged into the mains? Is the fuse OK?

Switch the unit on and wait three minutes to see if the issue is resolved.

Check whether the water tank is full.

If the unit still fails to operate call: 0871 620 1057

Office hours: 9AM - 5PM Monday to Friday

Unit J6 Lowfields Way

Elland West Yorkshire

HX5 9DA